

NOTE: BREAK ALL CORNERS WITH 0.015" (.38 MM) RADIUS UNLESS OTHERWISE NOTED. STANDARD TOLERANCES TO APPLY UNLESS OTHERWISE SPECIFIED.

CUSTOMER PART No.	CUSTOMER CAN ART STD.	DIE No. EH05406
DESCRIPTION 1.250" O.D. x 0.050" THK. ROUND TUBE		PROPOSAL No. H-2669

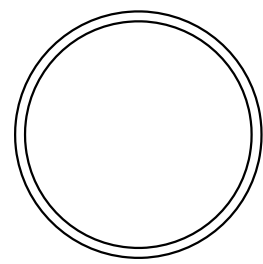
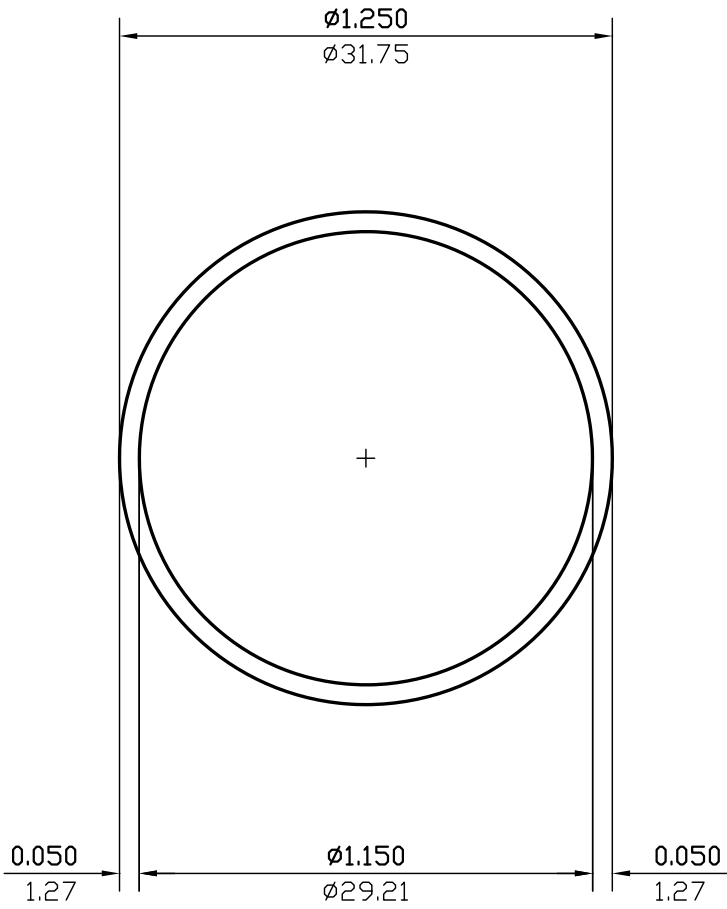

ACTUAL SIZE

WALL THICKNESS 0.050 (1.27) EXCEPT AS SHOWN

DATE	REV	DESCRIPTION	BY
03/10/23	2	REMOVED ALLOY	JASON
08/05/99	1	REDRAWN	P.M.

EST.AREA	0.188	IN. ²	EST.AREA	122	MM. ²
EST.WT.	0.222	LBS/FT.	EST.WT.	0.331	KG/M.
EST.PER.	7.540	IN.	EST.PER.	191.5	MM.
OUT PER.	3.927	IN.	OUT PER.	99.7	MM.
C.C.D.	1.250	IN.	C.C.D.	32	MM.
FACTOR	34	FINISH	M/F	ALLOY & TEMP.	
CKD BY		SCALE	2:1	DWN BY	C.P. DATE 11/03/92

CAN ART

ALUMINUM EXTRUSION INC.

85 PARKSHORE DRIVE
BRAMPTON, ONT L6T 5M1
TEL. NO. (905) 791-1464
FAX NO. (905) 791-9151
E-MAIL: canart@canart.com

THIS DRAWING IS NOT NECESSARILY A COPY OF YOUR ORIGINAL. PLEASE APPROVE DIMENSIONS AND TOLERANCES INDICATED. CAN ART ASSUMES NO RESPONSIBILITY EITHER TECHNICAL OR LEGAL FOR HAVING THIS SHAPE MADE. THE CUSTOMER AGREES TO FULLY PROTECT CAN ART ALUMINUM FROM CLAIMS OF OTHERS RESULTING FROM THIS SHAPE.

SIGNED: _____ DATE: _____